



Prop971

Off Plan Projects in the UAE. Curated Opportunities.



- **FEATURED PROJECTS:**

Access a curated list of top-tier off plan developments across Dubai, Abu Dhabi, and beyond.



- **INVESTMENT INSIGHTS:**

Receive market data and yield potential analysis for your selected properties.



- **TRUSTED DEVELOPERS:**

Connect only with verified and highly-rated UAE property developers.

Visit Us: www.prop971.com

Prop971 is a curated data platform for UAE off plan properties.

ELLINGTON
PROPERTIES

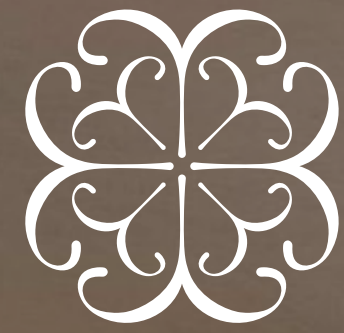

THE MERIVA
COLLECTION

SUNSET

GARDENS

SHORES



A welcome

from the ocean



MERIVA

SUNSET

Look out across uninterrupted ocean vistas from
The Meriva Collection's highest viewpoint.

Perched at the top of the collection, Meriva Sunset is for those who feel most alive in the quiet glow of evening light. Where the sunrises and sunsets cast an ever-changing canvas that transforms from morning calm to radiant dusk. Elevated terraces, soft interior palettes, and thoughtfully composed spaces draw the outside in, allowing every moment to unfold with ease. This is a place where days feel lighter, evenings stay with you longer, and residents have a front-row seat to the beauty of the horizon.

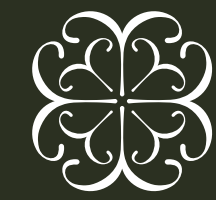

MERIVA GARDENS

Live a life soothed by nature, within lush gardens
and meandering waterways.

Meriva Gardens is a gentle retreat where greenery sets the rhythm of your days. Meandering paths guide you through shaded pockets, quiet seating alcoves, and flowing waterways that bring a sense of calm to every step. These tranquil homes are framed by soft landscaping and natural light, creating living spaces that feel grounded, refreshing, and deeply restorative. Mornings begin with birdsong, afternoons drift beneath leafy canopies, and evenings settle into a quiet, enveloping stillness.

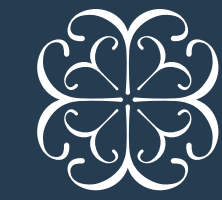

MERIVA SHORES

Begin every day in beachfront serenity, moments from the white sands and pristine waters.

Welcome to coastal living at its most natural. Where the beachfront becomes an extension of your home. Welcome the soft sea breeze through open terraces, and relish interiors shaped around natural textures. Whether it's a morning walk along the sands or a quiet evening by the water, residences at Meriva Shores bring you closer to the elements, inspiring clarity, calm, and a beautifully unhurried way of life.

Leave the city outside,
find serenity within





The *location*

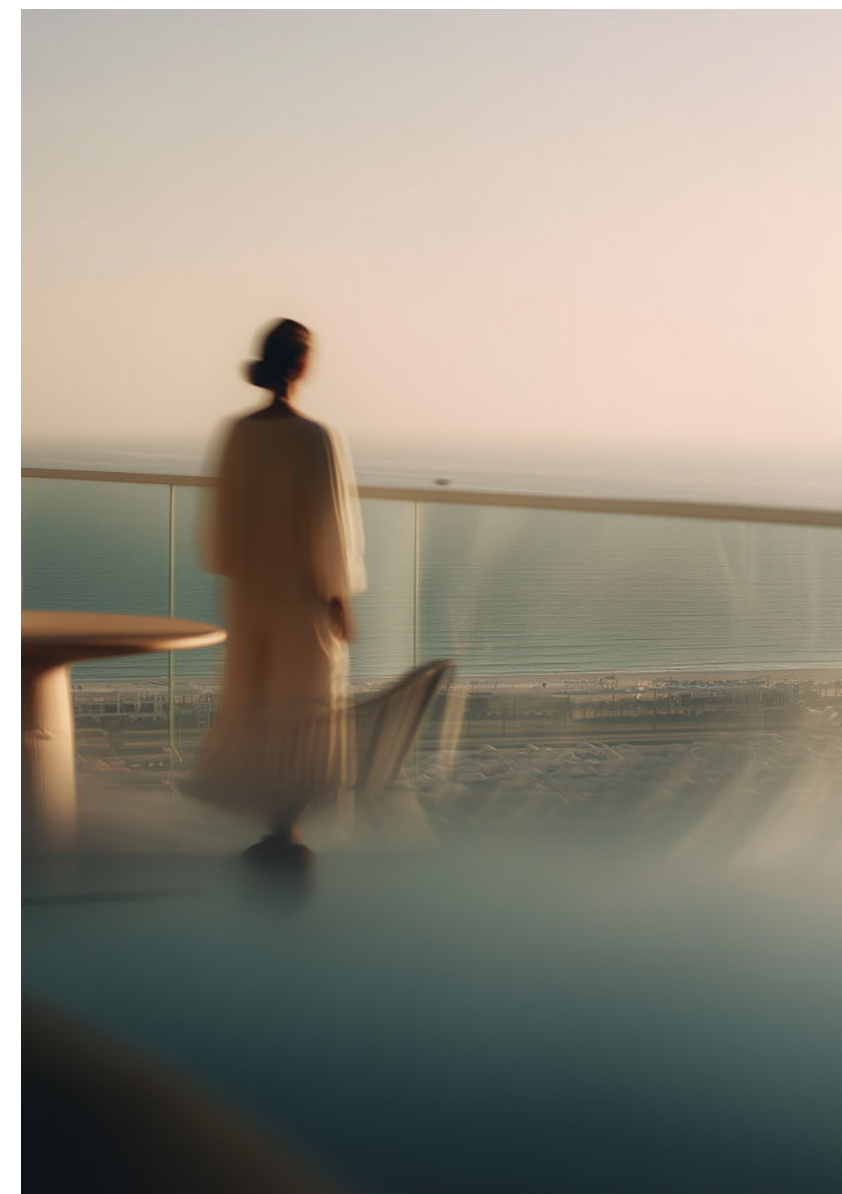

Meriva sits at the heart of a pedestrianised ocean-front enclave. Meandering waterways connect every building, garden, and amenity along an ambling pathway to the beach.

This thoughtfully designed environment encourages residents to walk, cycle, and explore, while maintaining easy access to nearby schools, business hubs, and lifestyle destinations.

Dubai Islands B



THE MERIVA
COLLECTION





<i>05 mins</i> Dubai Islands Mall	<i>18 mins</i> Dubai International Airport	<i>18 mins</i> Dubai Festival City Mall	<i>20 mins</i> Port Rashid	<i>20 mins</i> Gold Souq Metro Station (Green Line)
<i>25 mins</i> Museum of the Future	<i>30 mins</i> Dubai International Financial Centre (DIFC)	<i>35 mins</i> Burj Khalifa/Dubai Mall	<i>45 mins</i> Palm Jumeirah	<i>60 mins</i> Al Maktoum International Airport

METRO CONNECTIVITY MAP

- Red Line
- Green Line
- Future Extension Line
- Tram Line

The Sun & Views Analysis

SUNRISE

N

E

S

W

SUNSET



The Design *Philosophy*



Water body

Circulation

Green

Buildings

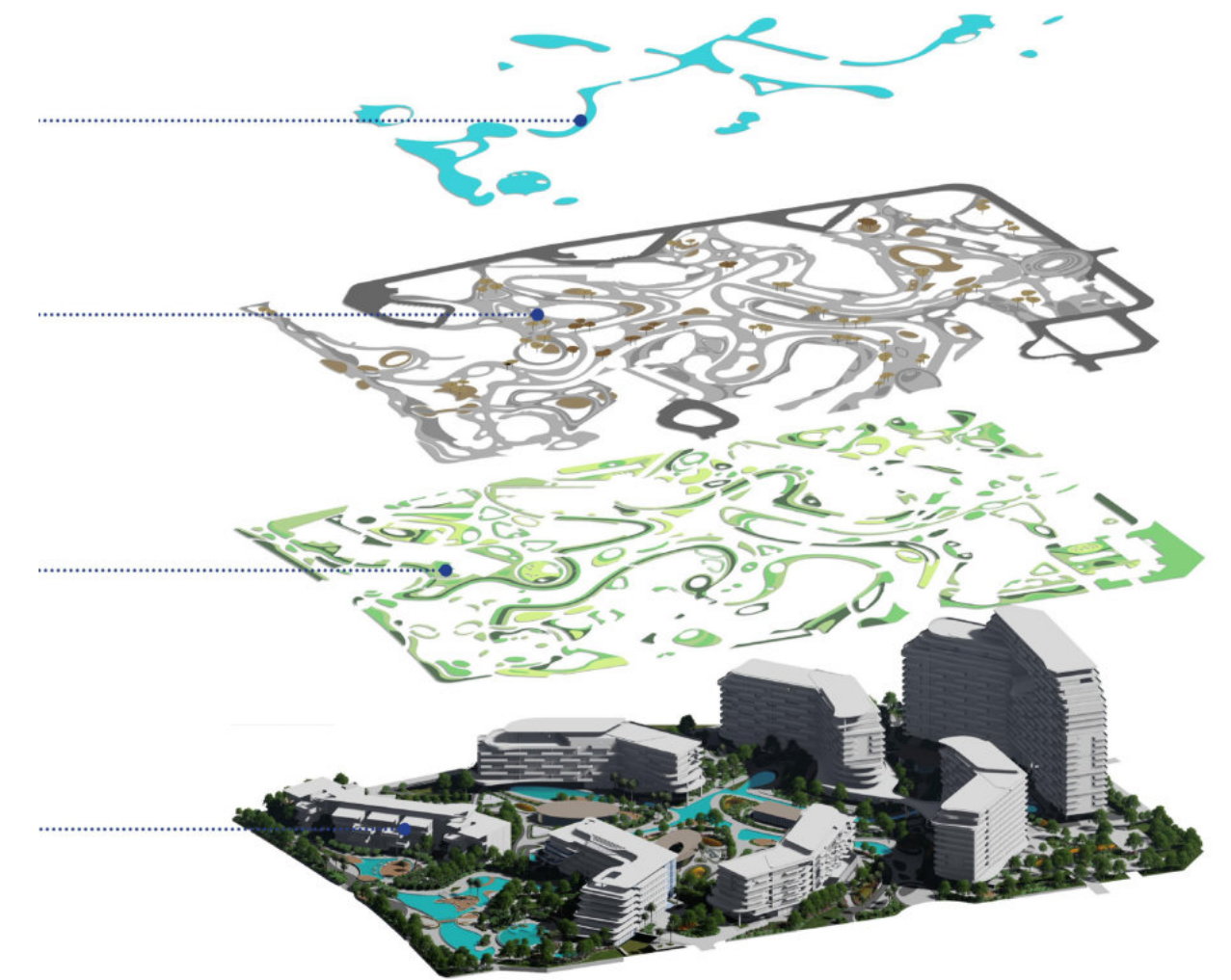

The project is inspired by the seamless curves and organic flow of nature, integrating architecture and landscape into one continuous composition. Soft, flowing lines shape the masterplan, guiding movement and framing views. Buildings are carefully positioned to embrace the lagoon and maximize visual connections to water and greenery, while the landscape becomes the connective tissue of the development.

The *Elevations*



North East Elevation (G+20)

The Building Configuration

MERIVA SUNSET



- Rooftop
- 20th Floor
- 19th Floor
- 18th Floor
- 17th Floor
- 16th Floor
- 15th Floor
- 14th Floor
- 13th Floor
- 12th Floor
- 11th Floor
- 10th Floor
- 9th Floor
- 8th Floor
- 7th Floor
- 6th Floor
- 5th Floor
- 4th Floor
- 3rd Floor
- 2nd Floor
- 1st Floor
- Ground Level
- Basement



Project *Configuration*

PARKING

1 Bedrooms	1 Parking Space
2 Bedrooms	1 Parking Space
3 Bedrooms	2 Parking Spaces
4 Bedrooms	2 Parking Spaces
Penthouses	3 Parking Spaces

ELEVATORS

6

OWNERSHIP

Freehold

ANTICIPATED COMPLETION DATE

Q2 2030

SERVICE CHARGE

AED 18 per sq. ft.

Number of Units *Per Type*

1 Bedroom	182 units
1 Bedroom Corner	12 units
2 Bedrooms	98 units
2 Bedrooms Corner	16 units
2 Bedrooms + S	15 units
2 Bedrooms + S Corner	28 units
2 Bedrooms + S Dual Aspect	3 units
3 Bedrooms	15 units
3 Bedrooms + S Dual Aspect	3 units
3 Bedrooms Penthouse	1 unit
4 Bedrooms Dual Aspect	3 units
4 Bedrooms Penthouse	1 unit

Size Rance Per *Unit Type*

1 Bedroom	from 832.33 sq. ft. to 880.48 sq. ft.
1 Bedroom Corner	from 1,007.24 sq. ft.
2 Bedrooms	from 1,272.38 sq. ft.
2 Bedrooms Corner	from 1,376.14 sq. ft.
2 Bedrooms + S	from 1,426.62 sq. ft.
2 Bedrooms + S Corner	from 1,492.01 sq. ft. to 2,121.31 sq. ft.
2 Bedrooms + S Dual Aspect	from 1,607.05 sq. ft.
3 Bedrooms	from 1,747.22 sq. ft.
3 Bedrooms + S Dual Aspect	from 2,170.67 sq. ft. to 2,345.99 sq. ft.
3 Bedrooms Penthouse	from 3,702.41 sq. ft.
4 Bedrooms Dual Aspect	from 3,050.35 sq. ft. to 3,176.97 sq. ft.
4 Bedrooms Penthouse	from 3,367.08 sq. ft. to 4,648.11 sq. ft.



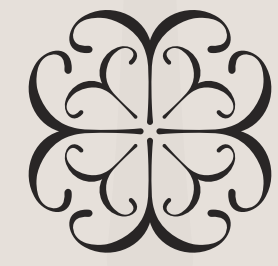

Ground floor
Amenities

Ground Floor Amenities Master Plan

- 01 VEHICLE ENTRANCE/EXIT
- 02 DROP-OFF AREA
- 03 CASCADING WATER FEATURES
- 04 LOBBY ENTRANCE
- 05 LOBBY RECEPTION
- 06 CLUB LOUNGE
- 07 JAZZ CLUB
- 08 LIFTS LOBBY
- 09 FITNESS STUDIO & JUICE BAR
- 10 YOGA & PILATES STUDIO
- 11 CHANGING ROOM WITH SAUNA, EXPERIENCE SHOWER & LAVENDAR ROOM
- 12 KIDS PLAY AREA
- 13 OUTDOOR FITNESS AREA
- 14 BARBEQUE AREA
- 15 SUN LOUNGERS AREA
- 16 ADULTS POOL
- 17 LAGOON WATER FEATURE
- 18 KIDS POOL
- 19 KIDS SPLASH AREA
- 20 OUTDOOR KIDS PLAY AREA
- 21 POOL BAR
- 22 POOL BAR SEATING AREA
- 23 JOGGING TRACK
- 24 PADEL COURT
- 25 BASKETBALL COURT
- 26 SEATING AREA
- 27 DELIVERY PARKING
- 28 MOVE-IN PARKING
- 29 PARKING ACCESS
- 30 ROCK SCULPTURE
- 31 SCOOTER & BIKE TRACK

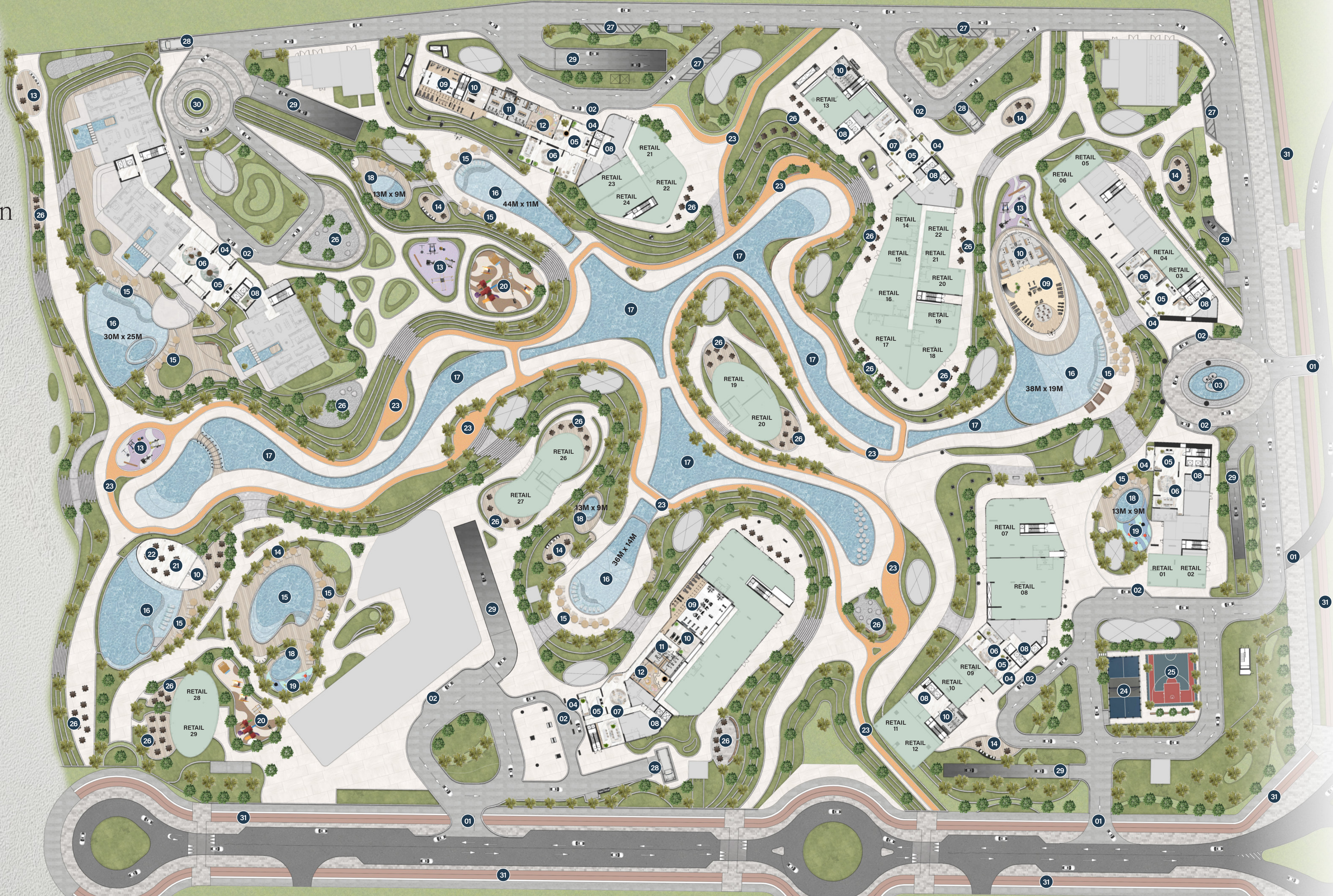



Drop Off Area



Lobby Reception



Lobby Lounge



Jazz Club



Jazz Dining



Pilates & Yoga Studio



INDOOR CYCLING STUDIO

CYCLE SQUAD

KEEP SPINNING

TIME TO SWEAT



HR 132
RPM 88
SPD 77
DIST 10.51 KM
WPTS 81
GRD -6.5%
CAL 43.6

Fitness bar

Handicap Room

Fitness Pavilion



INTERACTIVE ZONE

- Start
- Settings
- Explore
- Exit

Kids Play Area



Jogging Track

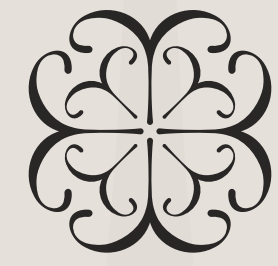

12th floor
Amenities

12th Floor Amenities Floor Plan

- 01 LIFT LOBBY
- 02 SERVICE LIFT
- 03 JUICE BAR
- 04 FEMALE CHANGING ROOM
- 05 MALE CHANGING ROOM
- 06 BATHROOM FOR PEOPLE OF DETERMINATION
- 07 SUN LOUNGERS
- 08 CABANA
- 09 LAP POOL
- 10 FITNESS ZONE
- 11 JACUZZI





Indoor *Pool*

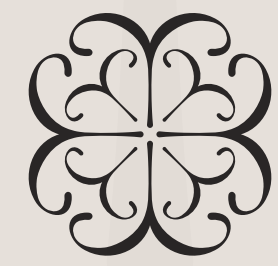

13th floor
Amenities

13th Floor Amenities Floor Plan

- 01 LOBBY LIFTS
- 02 SERVICE LIFT
- 03 GAMES TABLE
- 04 ADULTS POOL
- 05 SUN LOUNGERS
- 06 BARBEQUE DECK





Adults Pool



Games Room



Games Room *Seating*



17th floor
Amenities

17th Floor Amenities Floor Plan

- 01 LOBBY LIFTS
- 02 SERVICE LIFT
- 03 ACCESS TO MINI GOLF AREA
- 04 VIEWING DECK AREA
- 05 OUTDOOR GIANT CHESS
- 06 LAWN SEATING AREA
- 07 SEATING AREA
- 08 MINI GOLF

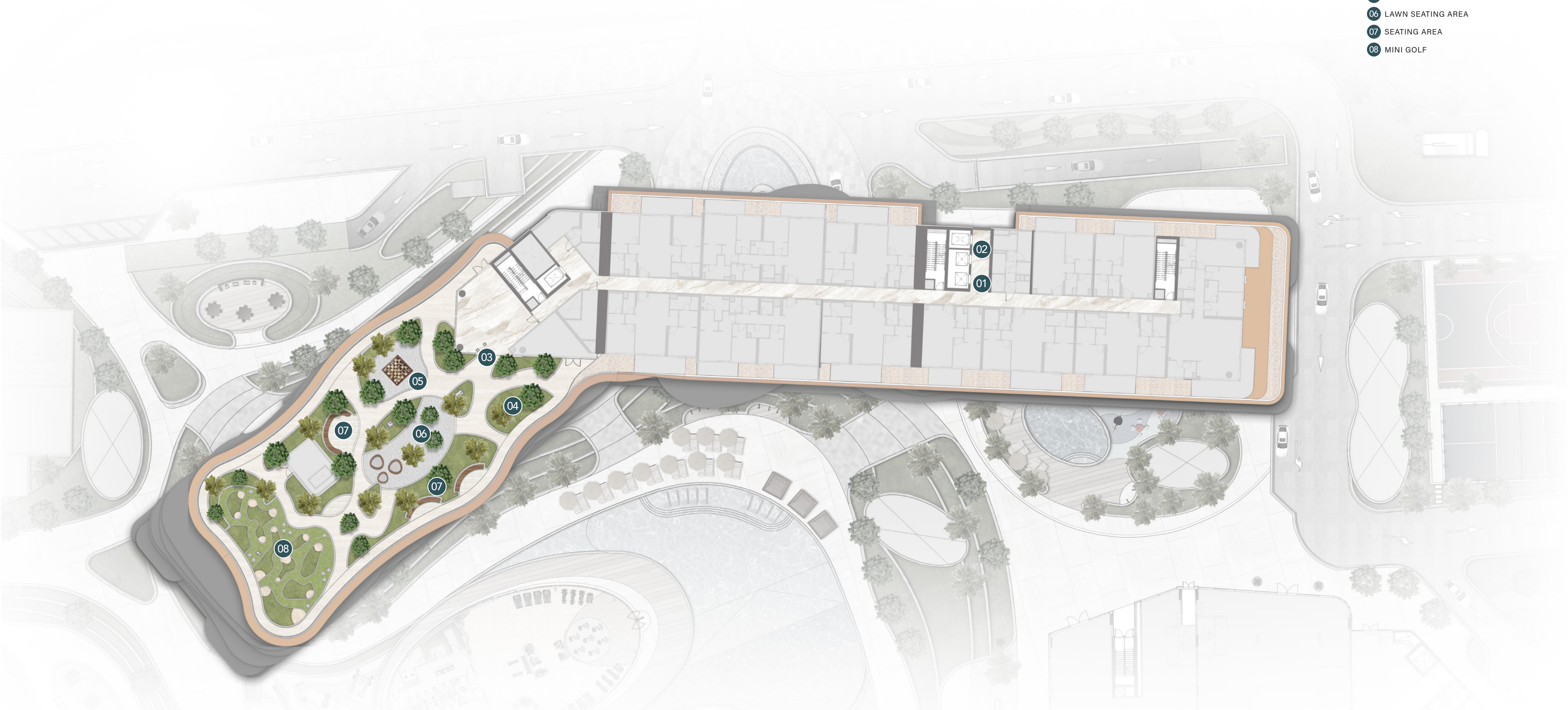



Viewing Deck

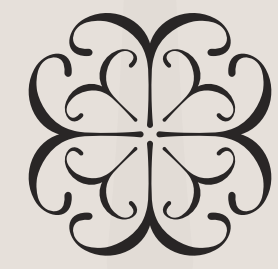

The
Residences



Living Room



Kitchen



Master Bedroom



Master Bathroom



Powder Room



Payment *plan*

20%

At the time
of booking

10%

60 Days after
reservation date

5%

120 Days after
reservation date

5%

180 Days after
reservation date

5%

240 Days after
reservation date

5%

360 Days after
reservation date

5%

On completion of 20%
construction of the project

5%

On completion of 30%
construction of the project

5%

On completion of 40%
construction of the project

5%

On completion of 50%
construction of the project

30%

On completion